

Dentil Shelf

INSTALLATION INSTRUCTIONS



MASONITE.

Open to extraordinary.



BEFORE YOU BEGIN

If the door has not been installed into the opening, protect the underside of the door by laying it flat on padded sawhorses or another padded surface. Position the door with the exterior side facing up.



1

Place the Mounting Bracket in the desired location - the center of the door and 3/8" below the bottom of the top panel, with the "This Side Door" marking against the door.

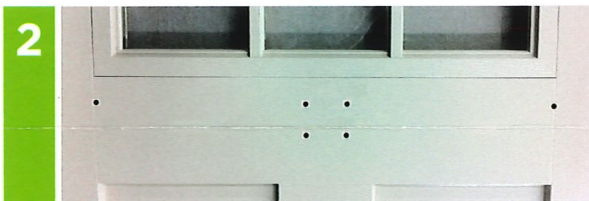

2

Use an awl or similar tool to transfer the six hole pattern (holes circled below) onto the face of door. Highlight the marks with a pencil.

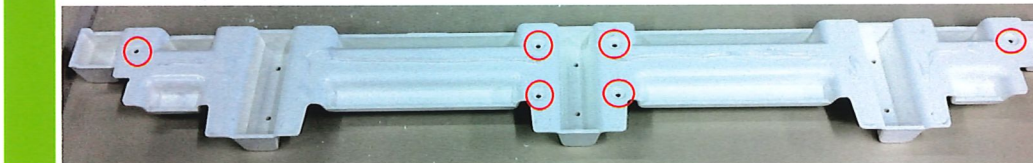

3

Drill (6) 3/16" holes into the face of the door at each location mark made in Step 2. Holes should be approximately 7/8" deep.

4

Thoroughly clean the door surface, the dentil shelf, and mounting bracket with mild soap and water. Be sure to thoroughly rinse with water to make sure all soap and residue are removed and then dry completely. Surfaces must be completely dry before continuing to the next step.

CAUTION

Make sure your work area is well-ventilated. Keep adhesive away from heat and flame. Avoid any contact with eyes and skin. Read warning label on adhesive. Instructions to locate the adhesive msds can be found on the adhesive package.

Keep adhesive out of reach of children!

REQUIRED MATERIALS

- ▶ Phillips Screwdriver
- ▶ Drill and 3/16" Drill Bit
- ▶ Rubber Mallet
- ▶ Awl
- ▶ Pencil
- ▶ Safety Glasses
- ▶ Soap & Water
- ▶ Utility Knife

SUPPLIES INCLUDED WITH DENTIL SHELF KIT

- ▶ Qty. 1 - Masonite Dentil Shelf
- ▶ Qty. 1 - Mounting Bracket
- ▶ Qty. 1 - 2.5 oz Tube Liquid Nails LN207 Adhesive
- ▶ Qty. 6 - Ribbed Plastic Anchors - #4-6 x 7/8"
- ▶ Qty. 6 - #6 x 1" Screws

NOTES

- ▶ Dentil Shelf is for decoration only - do not hang or rest anything from or on the shelf.
- ▶ For best results do not finish or paint the door and dentil shelf until after the dentil shelf has been installed.
- ▶ If the door is already completely painted or stained, sand the paint or stain off of the application area.

5 Apply a small amount of Liquid Nails into each hole drilled in step 3. Allow Liquid Nails to set for 5 minutes.

6 Install (1) Ribbed Plastic Anchor into each of the (6) holes. Lightly tap to seat with the mallet, if necessary. Allow 10 minutes for adhesive to cure around the anchors.



Apply a 3/16" bead of the Liquid Nails adhesive to the back of the Mounting Bracket. Do not get too close to edges to avoid squeeze out. Pattern shown below:

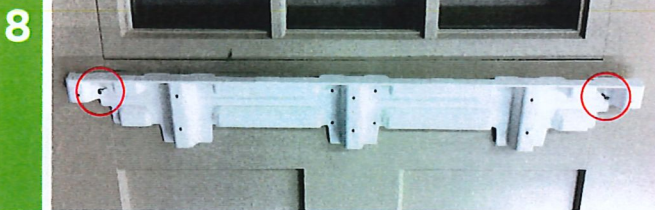

Using the two screws at either end of the Mounting Bracket, position the Dentil Shelf Mounting Bracket in place and press against the door.

9 Hand tighten (6) #6 x 1" screws into each of the holes in the Mounting Bracket. Do not over tighten.

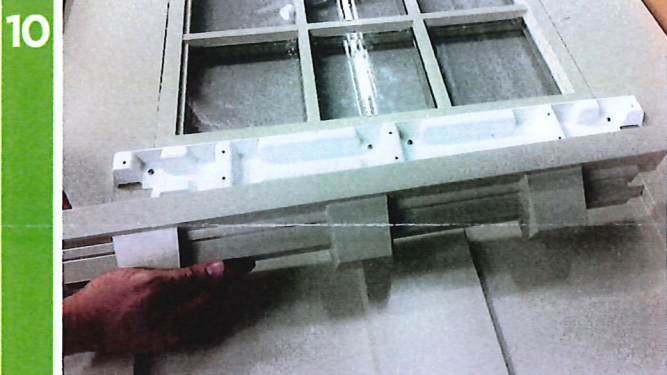

Place the Dentil Shelf over the bracket and push down until the Dentil Shelf clicks into place over the Mounting Bracket.