

For Factory Glazed Doors

Removing Plastic Film from Glass On Doors: (Factory Applied)

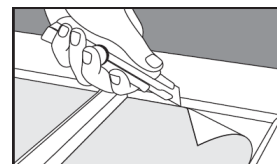

Figure 1

For factory glazed doors, we cover each pane of glass with plastic film to protect them during the application of finishing products such as paint. This plastic protection reduces the risks of paints on the glass. Do not remove the plastic until you have completed painting your door.

- On doors that have plastic film protection on glass, removal of plastic film protection immediately after applying the finish coat is required. Failure to remove the plastic film at this time may cause harm to the glass and will create difficulty in removing the film at a later time.
- Lay the glass doors on a flat horizontal surface then spray to saturate the film with a foamy glass cleaner or a Windex w/ vinegar-based glass cleaner, let saturate for 30 seconds to a minute.
- A razor knife is recommended to remove the film by carefully trimming the film from as close to the perimeter of the glass as possible to the glazing bead. Score the film mask with the blade of the knife inclined against the glazing bead and carefully cut at an angle of 45° (perpendicular) to the plane of the glass surface. This will prevent leaving a visible mark or scratch on the glass. (see Figure 1)
- DO NOT cut the film in the field of the glass or in any of the viewing area of the door glass. ONLY cut on the perimeter of the glass against the glazing bead. The razor knife may scratch the glass and all precautions must be met to not do so.
- Peel back one corner of the scored plastic film using a plastic scraper or another dull object, starting in one corner of the glass pane and SLOWLY peeling inward (if removed too quickly, a sticky residue will remain – to remove soak with glass cleaner then scrape with a plastic scraper).
- Repeat this process on other individual panes and on the other side of the door, if necessary.
- Wipe down door from excess cleaner with a paper towel.
- In the case that any residual primer or paint has made contact with the field or the viewing area of the glass, do not clean with a razor knife or sharp object.
- DO NOT use razor blades or metal scrapers of any size or type for cleaning glass

NOTE: It is the finisher's responsibility to protect glass prior to and during finishing. If using an after-market tape or film masking in the field, conduct a test of the tape or film being used on a small area of the glass before applying to a large surface. After finishing, remove the tape or film as soon as possible.

If the above instructions are not adhered to, any warranty will be voided.